

Paving Details Scale : 1:20 @ A1

Paving Detail 1 Scale : 1:25 @ A1

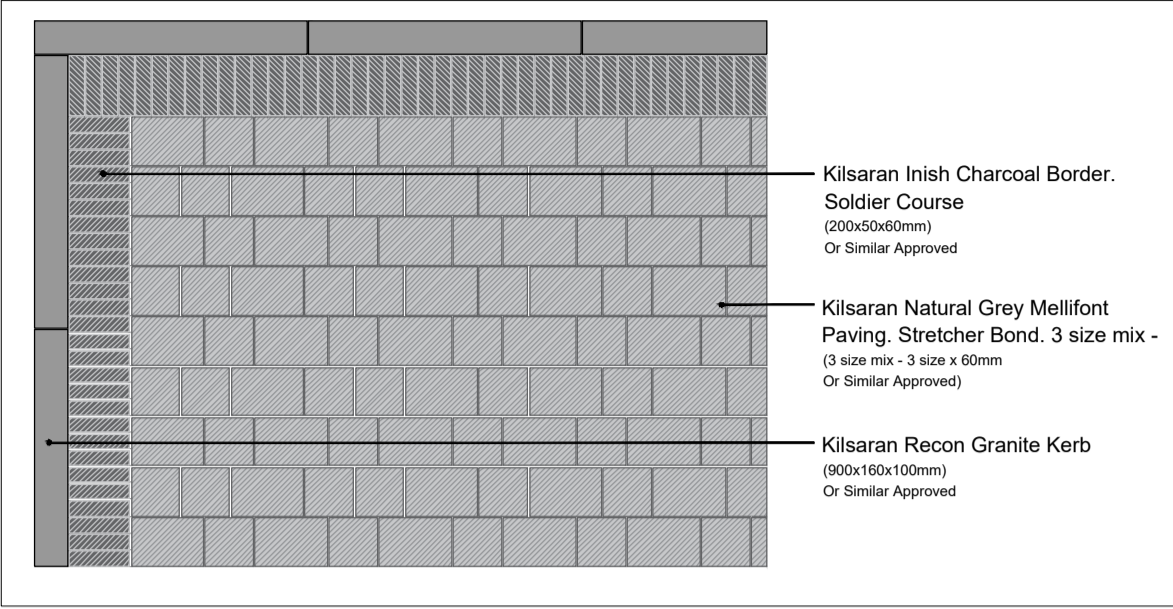

Paving Detail 6 & 7 Scale : 1:25 @ A1

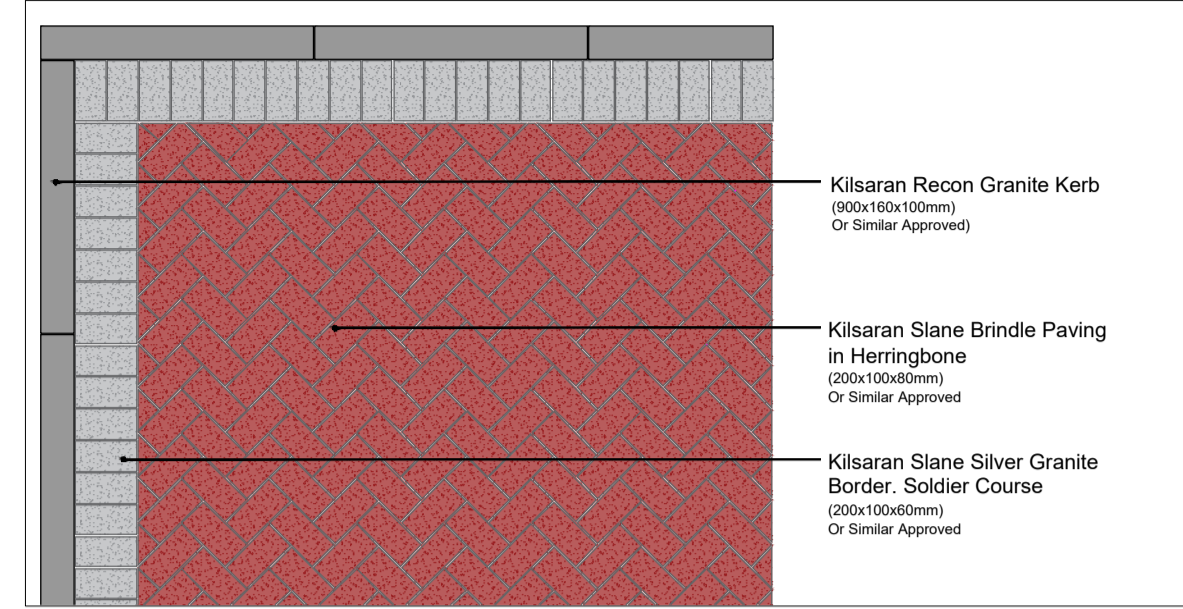

Paving Detail 2 Scale : 1:25 @ A1

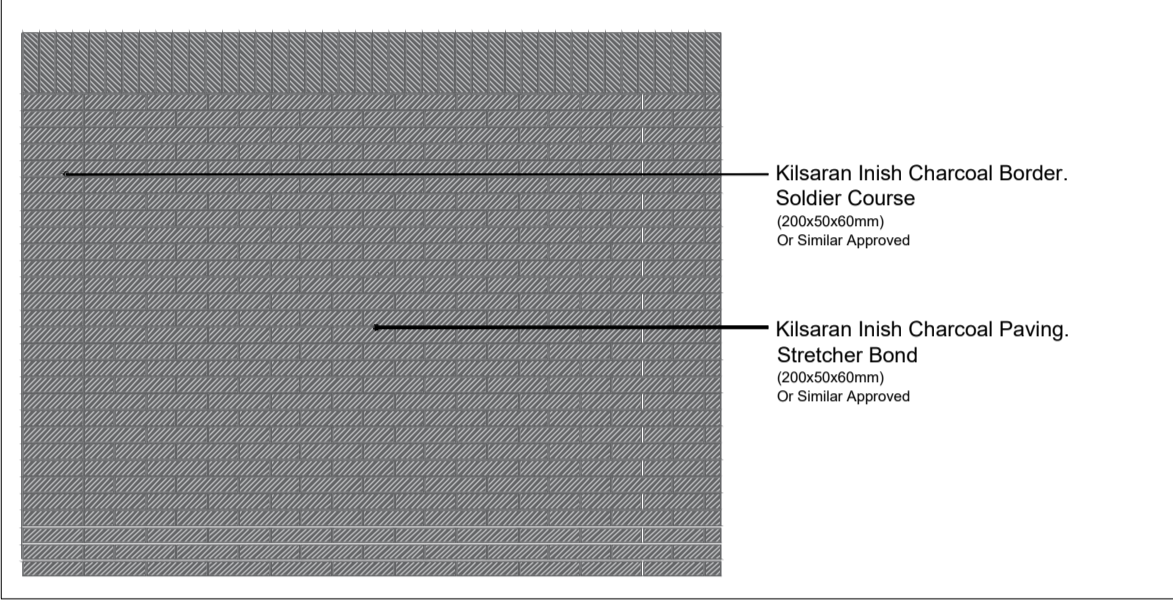

Paving Detail 8 Scale : 1:25 @ A1

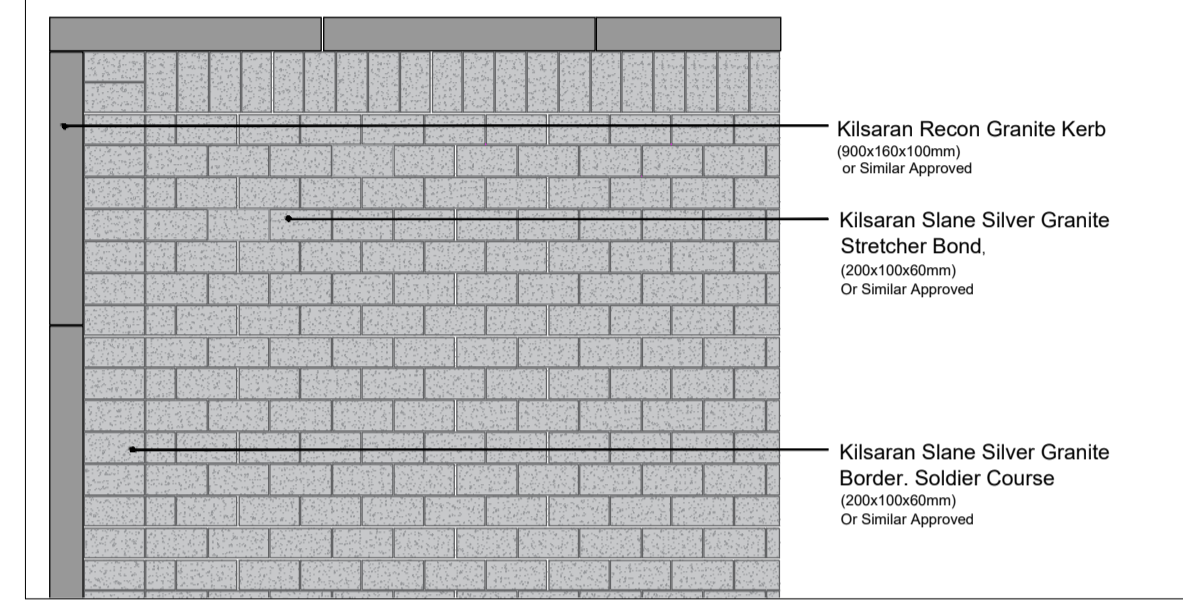

Paving Detail 3 Scale : 1:25 @ A1

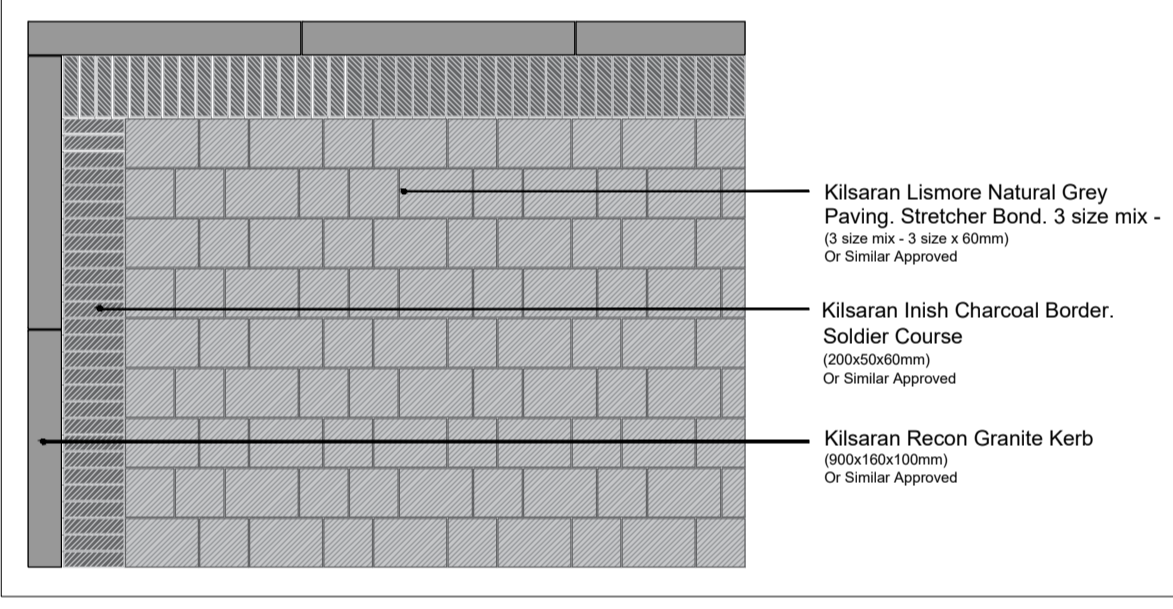

Paving Detail 9 Scale : 1:25 @ A1

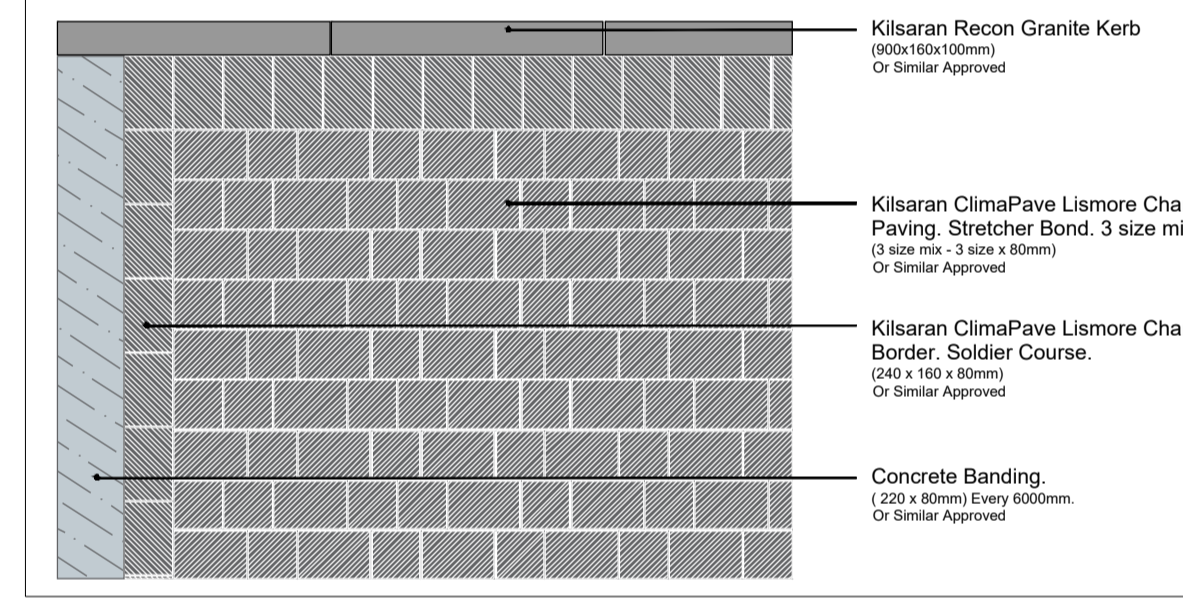

Paving Detail 4 Scale : 1:25 @ A1

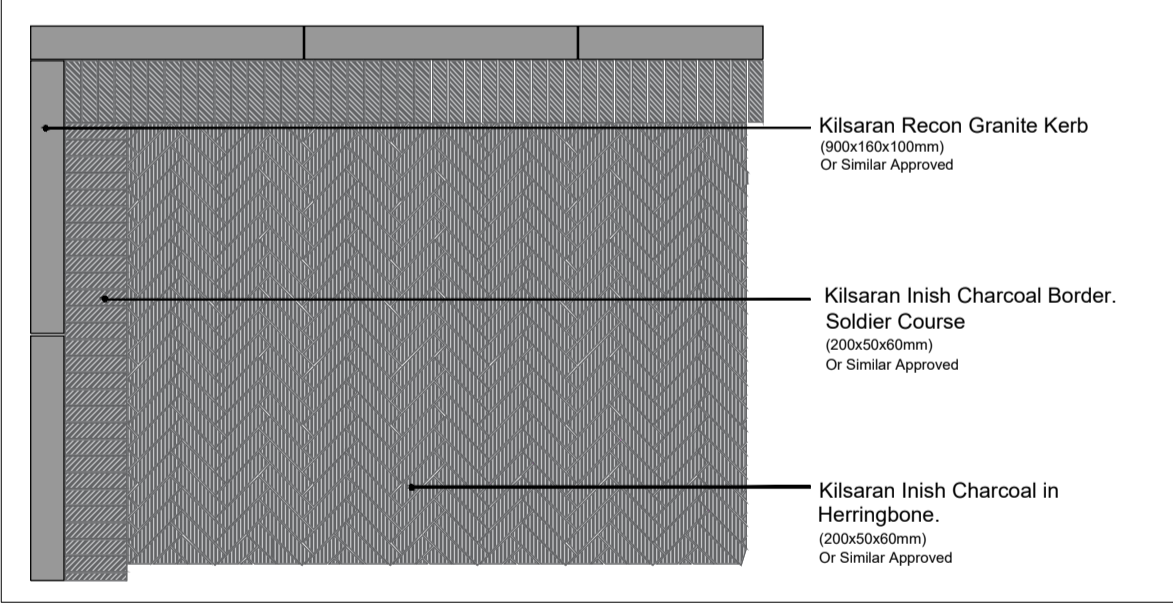

Paving Detail 10 Scale : 1:25 @ A1

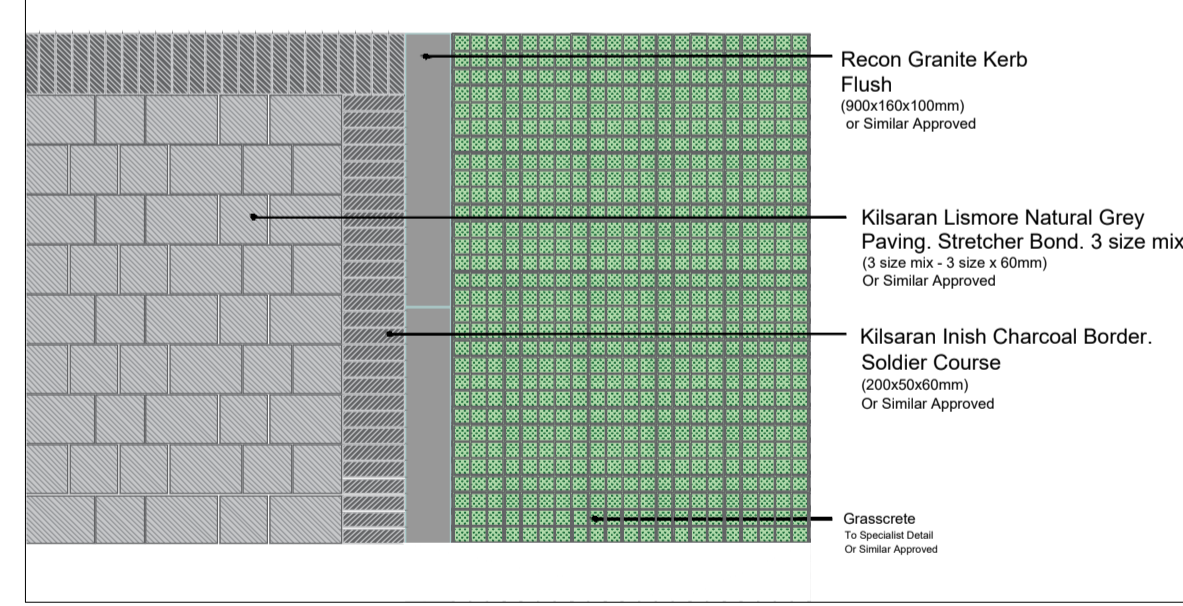

Paving Detail 5 Scale : 1:25 @ A1

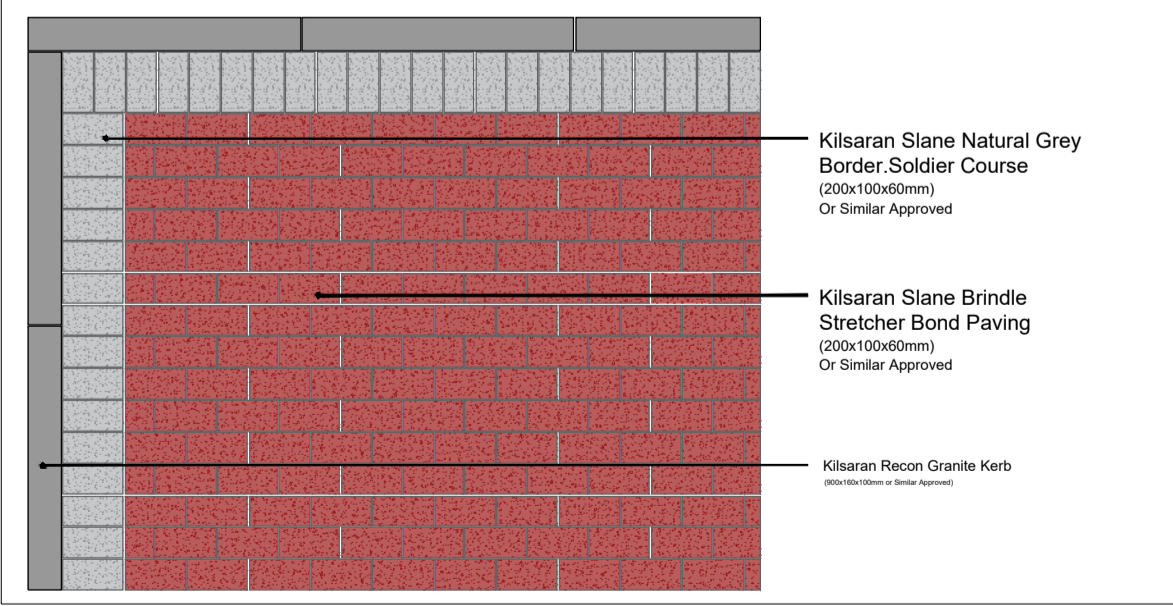

- Surface Treatment 1**
Kilsaran, Inish Natural Grey Mellifont, Stretcher Bond, 3 size mix Paving with Inish Charcoal border, Soldier Course, (200x50x60mm) Or similar approved. See Detail
- Surface Treatment 2**
Kilsaran, Inish charcoal (200x50x60mm) Stretcher Bond with Inish Charcoal border, Soldier Course, (200x50x60mm) Or similar approved. See Detail
- Surface Treatment 3**
Kilsaran, Lismore Natural Grey Paving, Stretcher Bond, 3 Size Mix with Inish Charcoal border, Soldier Course (200x50x60mm) Or similar approved. See Detail
- Surface Treatment 4**
Kilsaran, Inish Herringbone Charcoal (200x50x60mm) with Inish Charcoal border, Soldier Course (200x50x60mm) Or similar approved. See Detail
- Surface Treatment 5**
Kilsaran, Slane Brindle Stretcher Bond Permeable Paving (200x100x60mm) with Slane Natural Grey Border, Soldier Course, (200x100x60mm) or similar approved. See Detail

- Surface Treatment 6**
Kilsaran, Permeable Slane Brindle Paving in Herringbone (200x100x80mm) with Slane Silver Granite border, Soldier Course, (200x100x80mm) Or similar approved. See Detail
- Surface Treatment 7**
Kilsaran, Slane Brindle Paving in Herringbone (200x100x80mm) with Slane Silver Granite border, Soldier Course, (200x100x80mm) Or similar approved. See Detail
- Surface Treatment 8**
Kilsaran, Slane Silver Granite Stretcher Bond (200x100x60mm) with Slane Silver Granite border, Soldier Course, (200x100x60mm) Or similar approved
- Surface Treatment 9**
Kilsaran, KlimaPave Lismore in Charcoal, Stretcher Bond, 3 size mix x 80mm Paving with Lismore Charcoal border, Soldier Course, (240x160x80mm) Or similar approved. See Detail
- Surface Treatment 10**
Grasscrete/ Grass Mesh or similar approved

Context Map Scale : NTS



REV	DATE	BY	DESCRIPTION
A	03.11.2022	R.ON	Revised Layout
B	11.11.2022	R.ON	Revised Layout
C	06.12.2022	R.ON	Revised Layout
D	04.01.2023	R.ON	Revised Boundary Treatments
E	04.05.2023	R.ON	Revised layout
F	22.05.2023	R.ON	Revised Layout to Creche Outdoor Area
G	25.05.2023	R.ON	Revised Layout to Podium
H	07.08.2023	R.ON	Revised Paving to Turning Circle
I	21.08.2023	R.ON	Revised Layout to Podium finishes
J	01.09.2023	R.ON	Revised Entrance to Retail Unit
K	18.09.2023	R.ON	Revised Layout & Bicycle Stands
L	05.10.2023	R.ON	Revised Tree Planting to Public Realm
M	13.02.2024	R.ON	Revised Street Layout

Project Title: Resident development at Ballymount Road Lower, Walkinstown Co. Dublin	Dwg. No.: 06
Client: Montane Developments Ltd.	Scale: as shown (A1)
Drawing Title: Paving Details	Date: 26.08.2022
Job No.: 2022 - 1706	Drawing By: R.ON
	Checked By: RMD